

**** Note:** Part # 4G is the typical post. However, other sizes are available. Please refer to our brochure for available posts. Also, custom shapes can be designed to meet any special need.

The components and connection techniques shown herein are provided solely for use in incorporating "Aluminum Tube Railings" by ATR Technologies, Inc. into the overall project design and are the proprietary intellectual property of ATR Technologies, Inc. All rights reserved.

| | | | | | | | | |
|---|------------------|----------------|----------------------------------|--|--|--|------------------------|--|
| ATR TECHNOLOGIES, INC. 805 Towne Center Drive Pomona, California 91767-5901 (909) 399-9724 St. Lic. #679259 | | | REVISIONS | | Style 6D (2 Line) Glass Panel Guardrail | | SHEET 1 OF 1 | |
| | | | | | | | SCALE NONE | |
| | | | | | | | JOB NO. NONE | |
| | | | | | | | DATE 06/07/2010 | |
| DESIGN | DRAWN JRH | CHECKED | | | | | | |

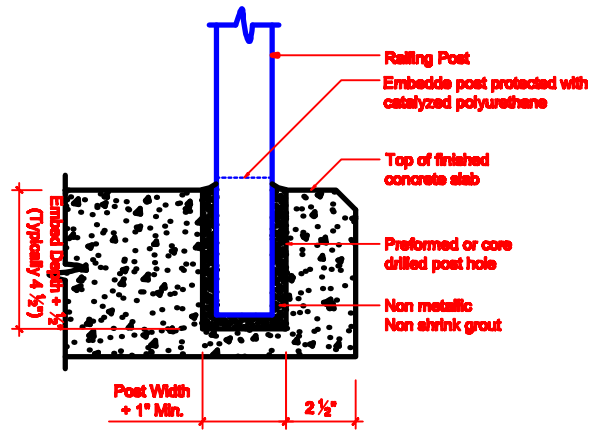

STYLE 5A EMBEDDED MOUNT

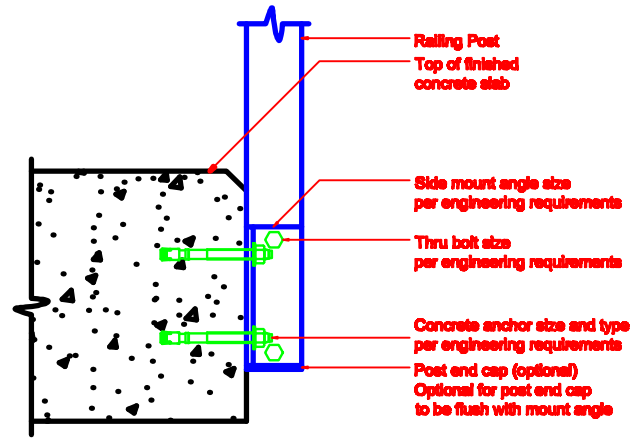

STYLE 5C SIDE MOUNT TO CONCRETE

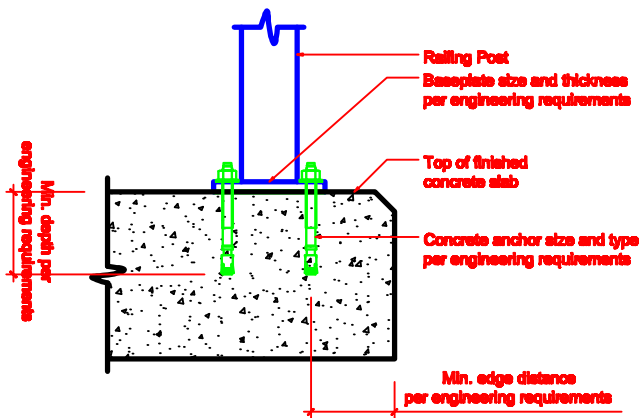

STYLE 5B BASEPLATE MOUNT TO CONCRETE

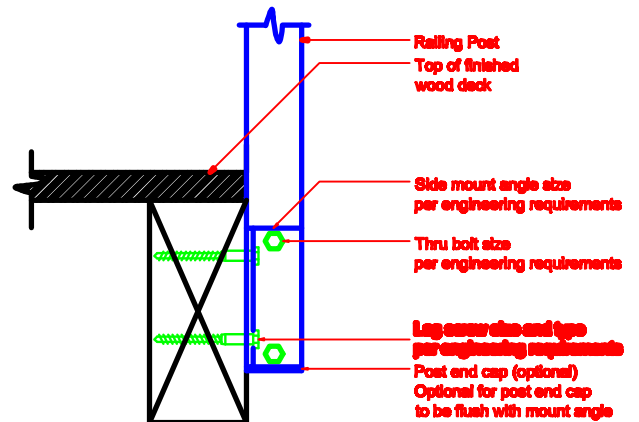

STYLE 5C SIDE MOUNT TO WOOD

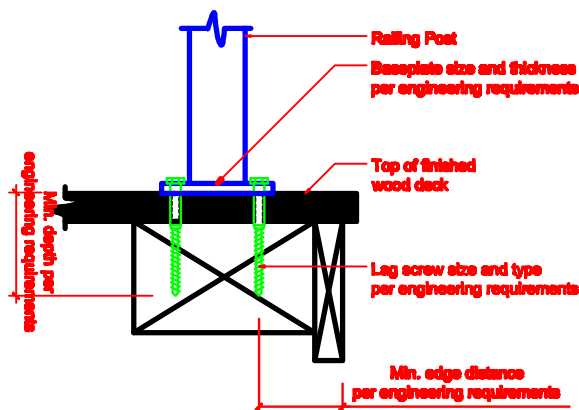

STYLE 5B BASEPLATE MOUNT TO WOOD

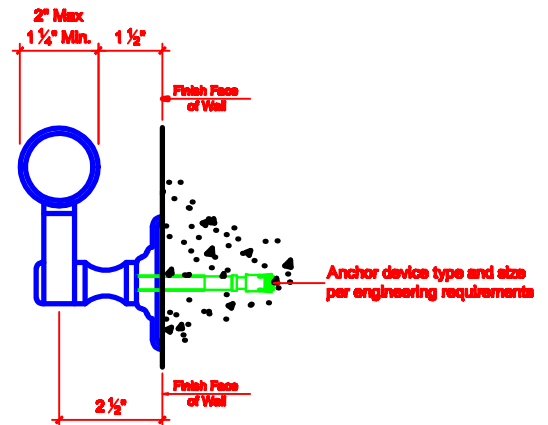

STYLE 5K WALL MOUNT HANDRAIL

ATR TECHNOLOGIES, INC.
805 Towne Center Drive
Pomona, California 91767-6901
(909) 396-9724 St. Lic. #679259

REVISIONS

Optional Mounting and Connection Details

SHEET 1 OF 1

SCALE NONE

JOB NO. NONE

DATE 06/07/2010

DESIGN DRAWN JRH CHECKED

Top Rails

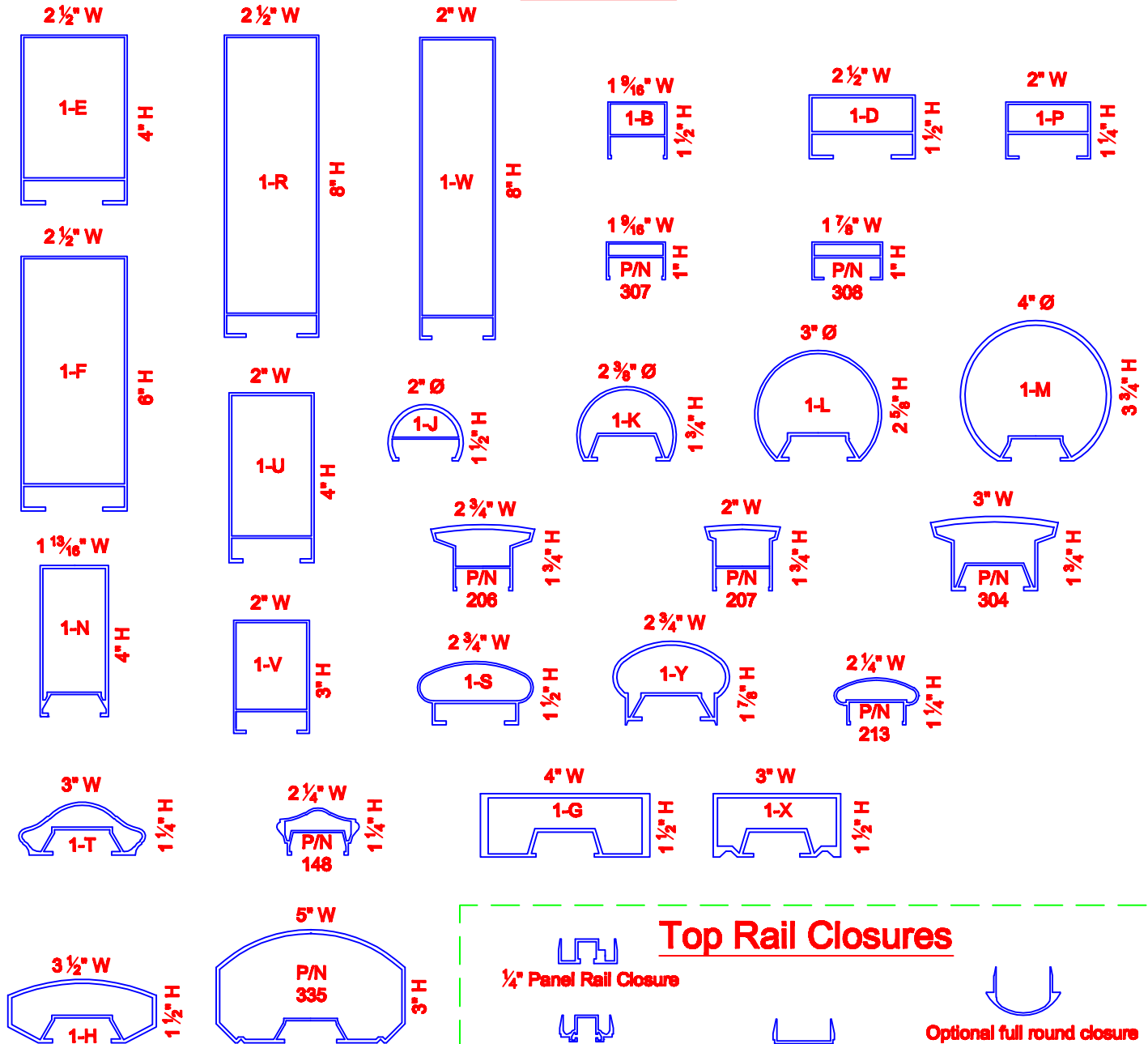

Top Rail Closures

Pickets

For 3/4" Systems

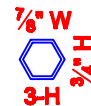

Pickets

For 1 1/4" Systems

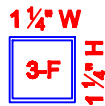
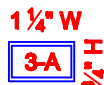

Custom shapes can be designed to meet any special need

The components and connection techniques shown herein are provided solely for use in incorporating "Aluminum Tube Railings" by ATR Technologies, Inc. into the overall project design and are the proprietary intellectual property of ATR Technologies, Inc. All rights reserved.

ATR TECHNOLOGIES, INC.

805 Towne Center Drive
Pomona, California 91767-6901
(909) 390-9724 St. Lic. #679259

REVISIONS

Optional Top Rails & Pickets

SHEET 1 OF 2

SCALE NONE

JOB NO. NONE

DATE 06/07/2010

DESIGN DRAWN JRH CHECKED

Bottom Rail

For $\frac{3}{4}$ " Pickets

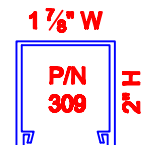
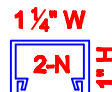
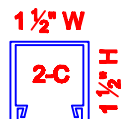
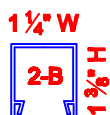

Bott. Rail

For $1 \frac{1}{4}$ " Pickets

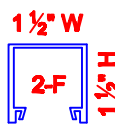
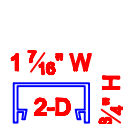

Bott. Rail

For $\frac{3}{4}$ " & $1 \frac{1}{4}$ " Pickets

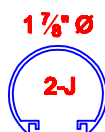

Bott. Rail Closures



Bottom Rail

For $\frac{1}{4}$ " Tempered Glass

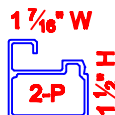

Bottom Rail

For $\frac{1}{4}$ ", $\frac{5}{16}$ " & $\frac{3}{8}$ " Tempered Glass

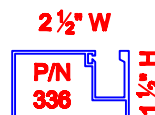
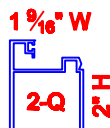

Glass Rail Closure



Posts

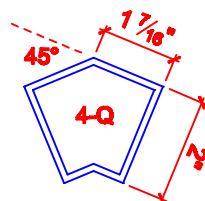
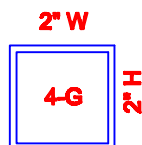
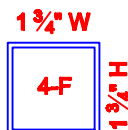
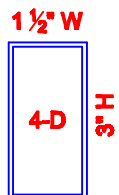
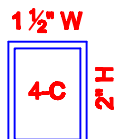
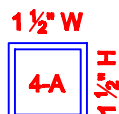

Handrails



Midrails

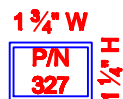

Midrails

For Use With Pickets

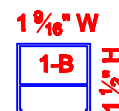

Handrail Brackets

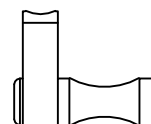
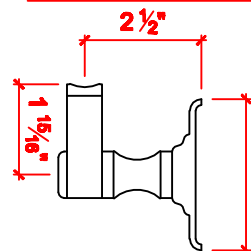

Custom shapes can be designed to meet any special need

The components and connection techniques shown herein are provided solely for use in incorporating "Aluminum Tube Railings" by ATR Technologies, Inc. into the overall project design and are the proprietary intellectual property of ATR Technologies, Inc. All rights reserved.

ATR TECHNOLOGIES, INC.

805 Towne Center Drive
Pomona, California 91767-6901
(909) 390-9724 St. Lic. #679259

REVISIONS

Optional Mid Rails, Bottom Rails, Posts and Handrails

SHEET 2 OF 2

SCALE NONE

JOB NO. NONE

DATE 06/07/2010

DESIGN DRAWN JRH CHECKED